

Einstellung Steuerkarte BC A5130

(alt)

K

alte Einstellung

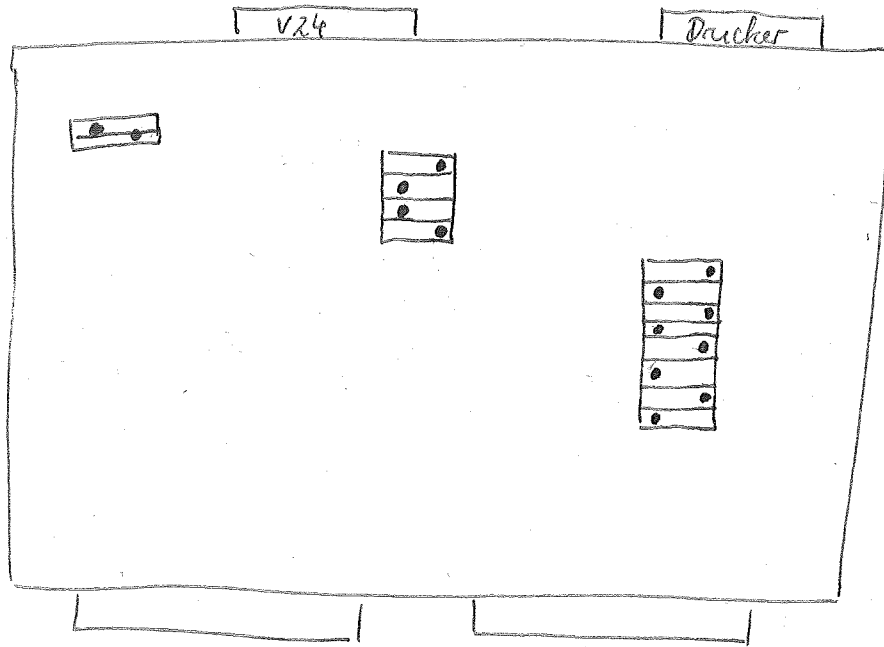

neue Einstellung (lt. IPF/Seifert)

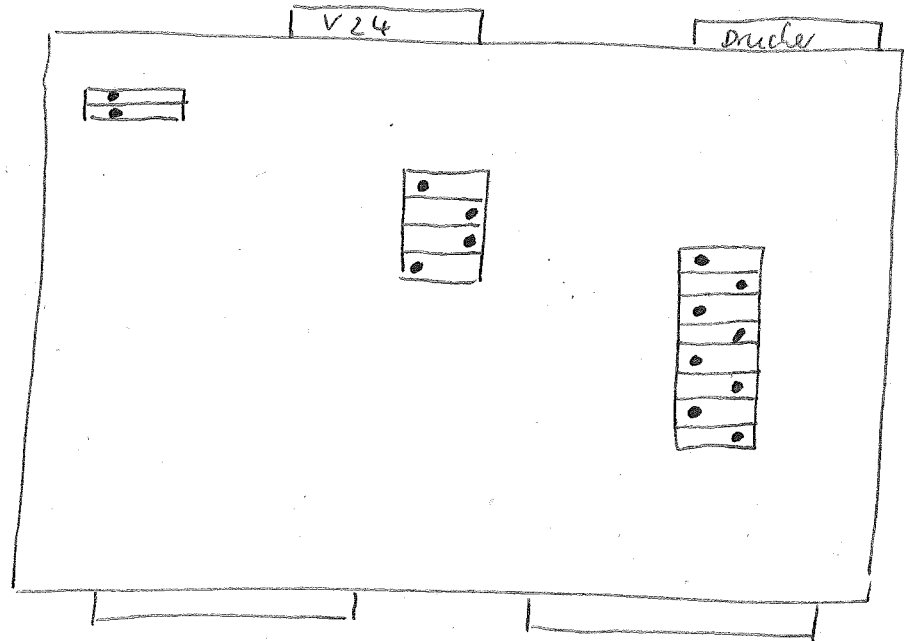

1 2 3 4 5 6 7 8

alt

M4A

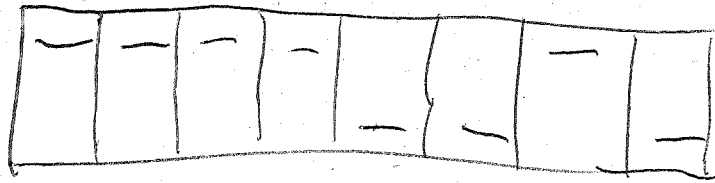

x x x

x Geschwindigkeitssens.

1 2 3 4 5 6 7 8

neu

M4A

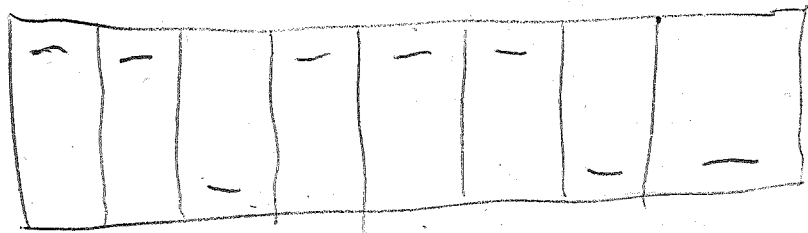

1 2 3 4 5 6 7

M6A

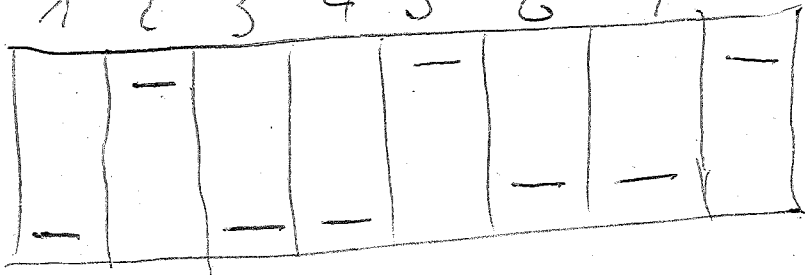

M46

4
3
2
1

